

<b>Алматы</b> (7273)495-231	<b>Иваново</b> (4932)77-34-06	<b>Магнитогорск</b> (3519)55-03-13	<b>Пермь</b> (342)205-81-47	<b>Тверь</b> (4822)63-31-35
<b>Ангарск</b> (3955)60-70-56	<b>Ижевск</b> (3412)26-03-58	<b>Москва</b> (495)268-04-70	<b>Ростов-на-Дону</b> (863)308-18-15	<b>Тольятти</b> (8482)63-91-07
<b>Архангельск</b> (8182)63-90-72	<b>Иркутск</b> (395)279-98-46	<b>Мурманск</b> (8152)59-64-93	<b>Рязань</b> (4912)46-61-64	<b>Томск</b> (3822)98-41-53
<b>Астрахань</b> (8512)99-46-04	<b>Казань</b> (843)206-01-48	<b>Набережные Челны</b> (8552)20-53-41	<b>Самара</b> (846)206-03-16	<b>Тула</b> (4872)33-79-87
<b>Барнаул</b> (3852)73-04-60	<b>Калининград</b> (4012)72-03-81	<b>Нижний Новгород</b> (831)429-08-12	<b>Саранск</b> (8342)22-96-24	<b>Тюмень</b> (3452)66-21-18
<b>Белгород</b> (4722)40-23-64	<b>Калуга</b> (4842)92-23-67	<b>Новокузнецк</b> (3843)20-46-81	<b>Санкт-Петербург</b> (812)309-46-40	<b>Ульяновск</b> (8422)24-23-59
<b>Благовещенск</b> (4162)22-76-07	<b>Кемерово</b> (3842)65-04-62	<b>Ноябрьск</b> (3496)41-32-12	<b>Саратов</b> (845)249-38-78	<b>Улан-Удэ</b> (3012)59-97-51
<b>Брянск</b> (4832)59-03-52	<b>Киров</b> (8332)68-02-04	<b>Новосибирск</b> (383)227-86-73	<b>Севастополь</b> (8692)22-31-93	<b>Уфа</b> (347)229-48-12
<b>Владивосток</b> (423)249-28-31	<b>Коломна</b> (4966)23-41-49	<b>Омск</b> (3812)21-46-40	<b>Симферополь</b> (3652)67-13-56	<b>Хабаровск</b> (4212)92-98-04
<b>Владикавказ</b> (8672)28-90-48	<b>Кострома</b> (4942)77-07-48	<b>Орел</b> (4862)44-53-42	<b>Смоленск</b> (4812)29-41-54	<b>Чебоксары</b> (8352)28-53-07
<b>Владимир</b> (4922)49-43-18	<b>Краснодар</b> (861)203-40-90	<b>Оренбург</b> (3532)37-68-04	<b>Сочи</b> (862)225-72-31	<b>Челябинск</b> (351)202-03-61
<b>Волгоград</b> (844)278-03-48	<b>Красноярск</b> (391)204-63-61	<b>Пенза</b> (8412)22-31-16	<b>Ставрополь</b> (8652)20-65-13	<b>Череповец</b> (8202)49-02-64
<b>Вологда</b> (8172)26-41-59	<b>Курск</b> (4712)77-13-04	<b>Петрозаводск</b> (8142)55-98-37	<b>Сургут</b> (3462)77-98-35	<b>Чита</b> (3022)38-34-83
<b>Воронеж</b> (473)204-51-73	<b>Курган</b> (3522)50-90-47	<b>Псков</b> (8112)59-10-37	<b>Сыктывкар</b> (8212)25-95-17	<b>Якутск</b> (4112)23-90-97
<b>Екатеринбург</b> (343)384-55-89	<b>Липецк</b> (4742)52-20-81		<b>Тамбов</b> (4752)50-40-97	<b>Ярославль</b> (4852)69-52-93

Россия +7(495)268-04-70

Казахстан +7(7172)727-132

Киргизия +996(312)96-26-47

[www.fourwinds.nt-rt.ru](http://www.fourwinds.nt-rt.ru) | | [fse@nt-rt.ru](mailto:fse@nt-rt.ru)

## Технические характеристики на мебельные петли компании **Four Winds**

**Виды товаров:** скрытые накладные, самозакрывающиеся, быстрого монтажа, ломберные, цилиндрические, карточные, прикладные, съемные, пружинные дверные, шарнирные разъемные, полунакладные, врезные, потайные, угловые, ввертные, двухсторонние, маятниковые, аксессуары, демперы и др.

# 04-1 Concealed Cup Hinges

## 105° or 95° Concealed Cup Hinge - Clip on type

- \* Drilling: Ø35mmxdepth 11.5mm
- \* 45mm or 52mm C.C.
- \* Material: steel

\* Full overaly

F	H	2	4
3	17	15	
4	18	16	
5	19	17	
6	20	18	

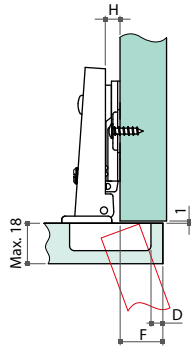

Item No.	Door opening angle
U2711	105°
U2712	95°

\* Half overaly

F	H	2	4
3	8	6	
4	9	7	
5	10	8	
6	11	9	

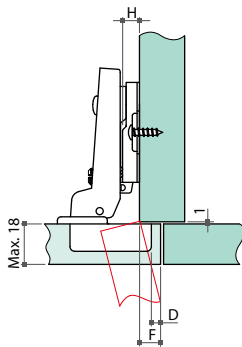

Item No.	Door opening angle
U2715	105°
U2716	95°

\* Inset

L	H	4
3	2	
4	1	
5	0	

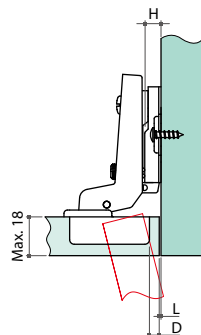

Item No.	Door opening angle
U2718	105°
U2719	95°

# 04-1 Concealed Cup Hinges

## 30°, 45° or 90° Concealed Cup Hinge - Clip on type

- \* Ø35mm cup hinge
- \* Material: zinc die casting
- \* Finish: nickel plated
- \* Spring loaded self-closing
- \* Maximum door thickness: 21 mm

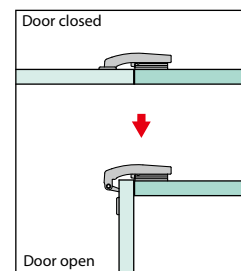

### 30° corner cabinet

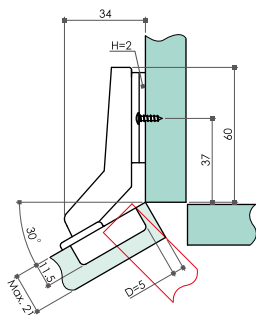

Item No.	Hinge type	Door opening angle
U2726	30°	105°

### 45° corner cabinet

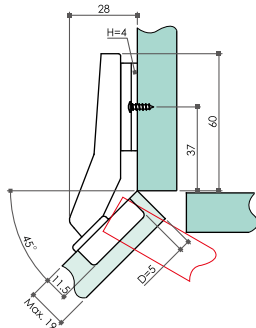

Item No.	Hinge type	Door opening angle
U2727	45°	105°

### 90° blind corner cabinet

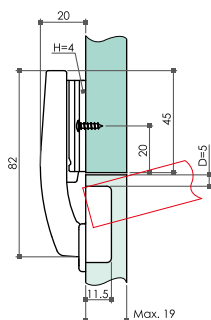

Item No.	Hinge type	Door opening angle
U2728	90°	105°

# 04-1 Concealed Cup Hinges

## U2729 Pie-cup Corner Hinge - Clip on type

- \* Ø35mm cup hinge
- \* Zamak arm, nickel plated

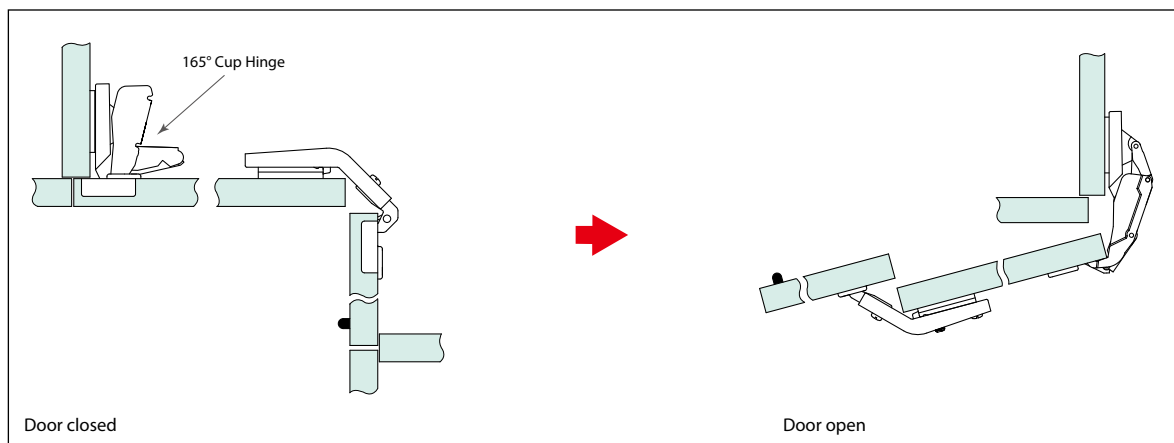
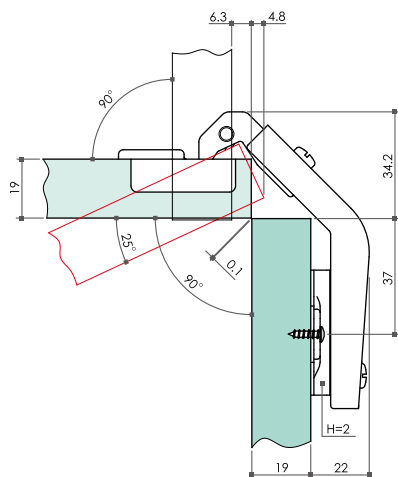

# 04-1 Concealed Cup Hinges

## Aluminium Frame Door Hinge - Clip on type

\* Material: zinc die casting cup

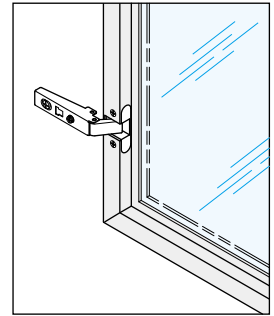

\* Full overaly

F	H	2	4
18	15	13	
19	16	14	
20	17	15	
21	18	16	

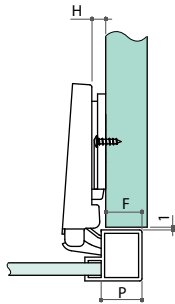

Item No.	Door opening angle
U2745	95°

\* Half overaly

F	H	2	4
18	7	5	
19	8	6	
20	9	7	
21	10	8	

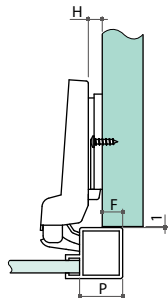

Item No.	Door opening angle
U2747	95°

\* Inset

L	H	4
18	1	
19	0	

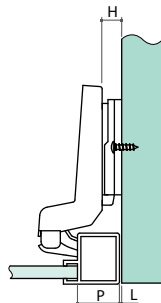

Item No.	Door opening angle
U2748	95°

# 04-1 Concealed Cup Hinges

## 180° Concealed Cup Hinge - Clip on type

- \* Ø35mm cup hinge
- \* Finish: nickel plated
- \* Spring loaded self-closing

Full overaly door  
\* Material: steel

F	H	2	4
3	14	12	
4	15	13	
5	16	14	
6	17	15	
7	18	16	

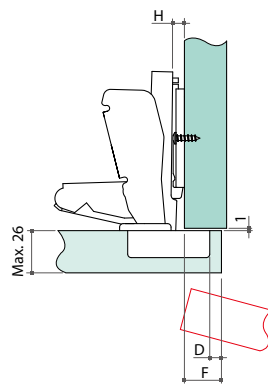

Item No.	Door opening angle
U2735	180°

Half overal  
\* Material: zinc die casting

F	H	2	4
3	7	5	
4	8	6	
5	9	7	
6	10	8	
7	11	9	

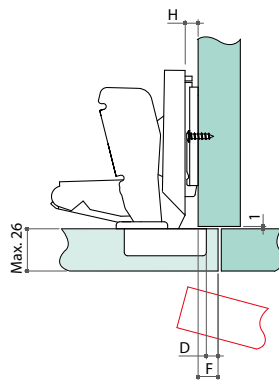

Item No.	Door opening angle
U2737	180°

# 04-1 Concealed Cup Hinges

## Mounting Plate for Clip on Hinge

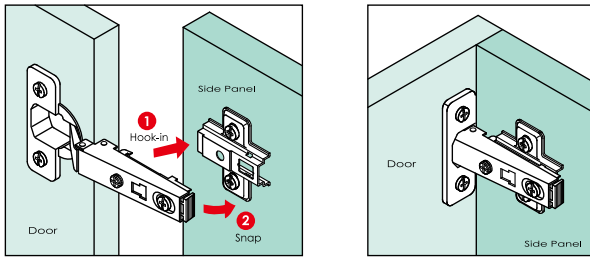

\* Chipboard screw

Item No.	Height (H)	Mounting method
UMT202	2	chipboard screw
UMT204	4	

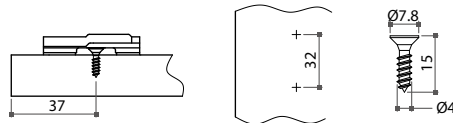

\* Chipboard screw (with 4 screw holes)

Item No.	Height (H)	Mounting method
UMT253	3	chipboard screw (with 4 screw holes)
UMT254	4	

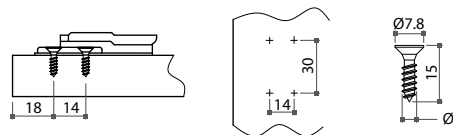

\* Premounted with Euro screws

Item No.	Height (H)	Mounting method
UMT212	2	premouted with Euro screws
UMT214	4	

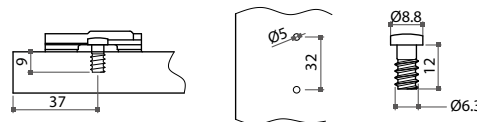

\* Premouted with wood screws

Item No.	Height (H)	Mounting method
UMT232	2	premouted with wood screws
UMT234	4	

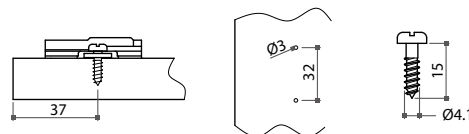

\* Ø5mm nylon expansion nut fixing

Item No.	Height (H)	Mounting method
UMT222	2	Ø5mm nylon expansion nut fixing
UMT224	4	

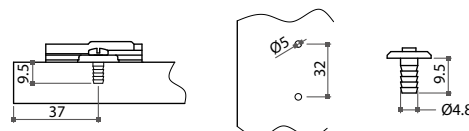

# 04-1 Concealed Cup Hinges

## Mounting Plate With Vertical Adjustment ( $\pm 2\text{mm}$ ) For Clip on Hinge

\* Chipboard screw (with 3 screw holes)

Item No.	Height (H)	Mounting method
UMT262	2	chipboard screw (with 3 screw holes)
UMT264	4	
UMT266	6	

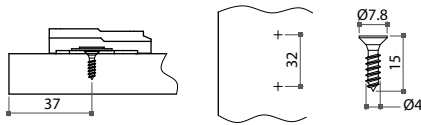

\* Chipboard screw (with 4 screw holes)

Item No.	Height (H)	Mounting method
UMT272	2	chipboard screw (with 4 screw holes)
UMT274	4	
UMT276	6	

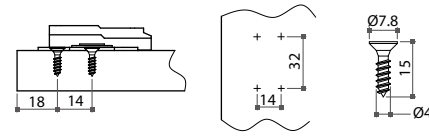

## Cup Hinge Accessories

### SC100 Steel Cover

\* For  $\varnothing 35\text{mm}$  cup hinge, nickel plated



### Hydraulic Soft-Closing Damper



**D100**  
\* For full overlay



**D200**  
\* For half overlay or inset

### PT100 Push-to-Open Hinge

\* With plastic push latch and square or round strike

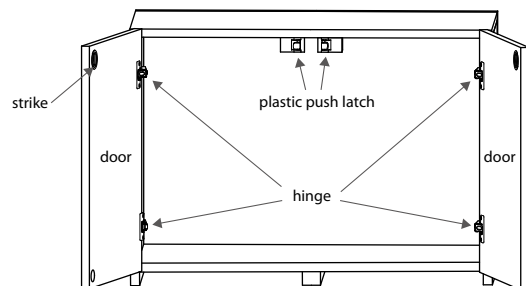



# 04-1 Concealed Cup Hinges

## Ø26mm Face Frame Concealed Hinge

- \* Ø26mm cup hinge, 10.7mm depth
- \* 105° door opening angle
- \* Steel, nickel plated
- \* Spring loaded self-closing
- \* Three dimensions of adjustment

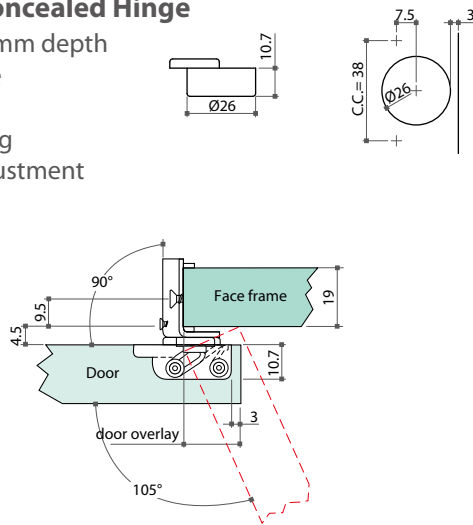

Item No.	Door overlay
27264	1/2"
27265	5/8"

## Ø35mm Face Frame Concealed Hinge

- \* Ø35mm cup hinge, 10.7mm depth
- \* 105° door opening angle
- \* Steel, nickel plated
- \* Spring loaded self-closing
- \* Three dimensions of adjustment

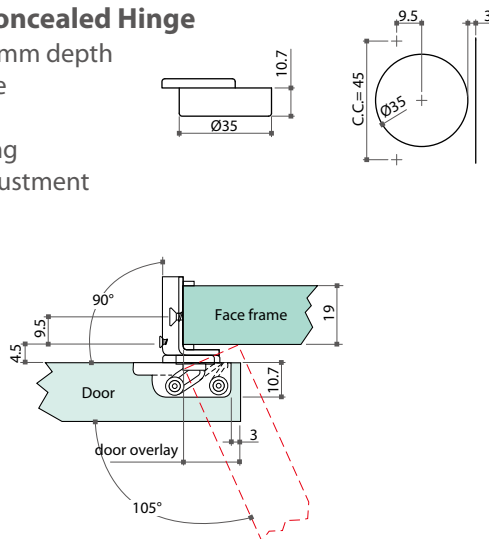

Item No.	Door overlay
27354	1/2"
27355	5/8"

## Face Frame Concealed Hinge

- \* Ø35mm cup hinge, 11.5mm depth
- \* 95° door opening angle
- \* Steel cup, zamak crank, nickel plated
- \* Spring loaded self-closing
- \* Mounting type: slide on

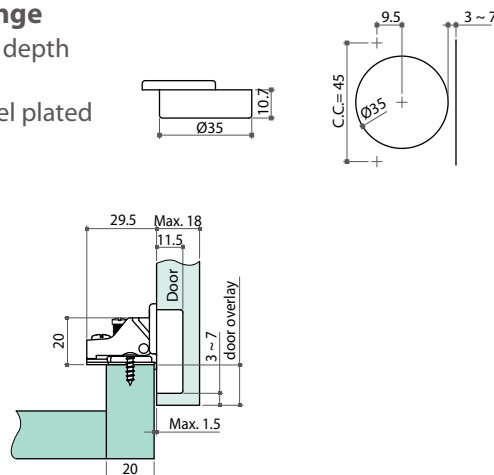

Item No.	Door overlay
22854	5/8"
22855	1/2"

# 04-2 Wide-Open Hinges

## 22740 Wide Angle Single Pivot Hinge

- \* 270° opening angle and 15.5mm door overlay
- \* Side panel mounting
- \* Zamak, nickel plated, with spring catch
- \* Complete with two plastic covers and one 3mm spacer

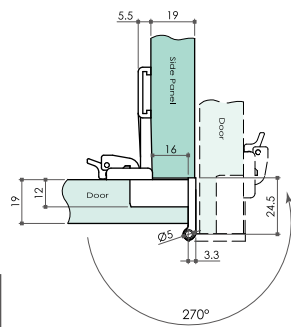
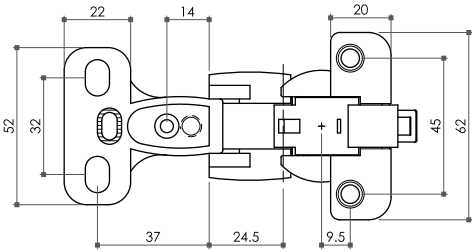

Item No.	Door opening angle
22740	270°

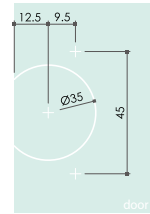
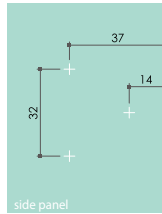

227-P03A  
Cover plate



227-P33  
3mm space plate



227-P03B  
Clip-on safety cover



## 22770 Wide Angle Single Pivot Hinge

- \* 230° opening angle and 6.5mm door overlay
- \* Side panel mounting
- \* Zamak, nickel plated, with spring catch
- \* Available with nylon dowels (Ø10mm) for hinge cup mounting plate and press-in expansion (Ø5mm) for adjustment

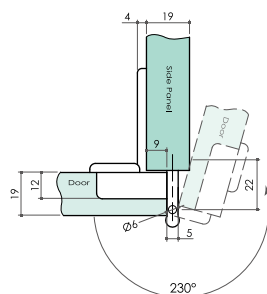
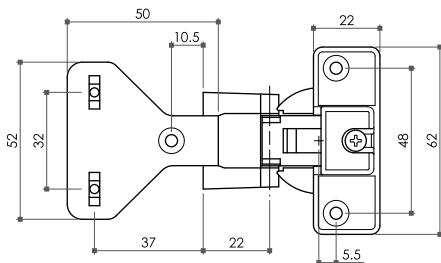

Item No.	Door opening angle
22770	230°

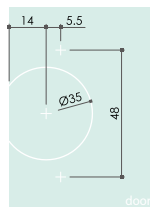
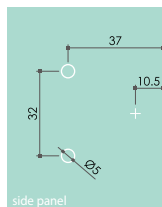

# 04-2 Wide-Open Hinges

## 22775 Wide Angle Single Pivot Hinge

- \* 270° opening angle and 15mm door overlay
- \* Side panel mounting
- \* Zamak, nickel plated, with spring catch
- \* Available with nylon dowels (Ø10mm) for hinge cup mounting plate and press-in expansion (Ø5mm) for adjustment

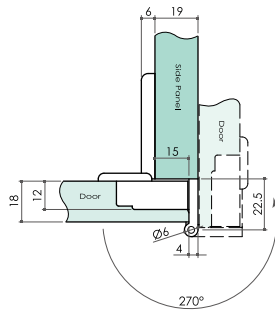
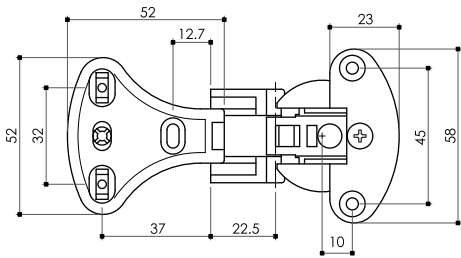
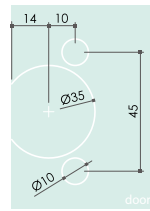
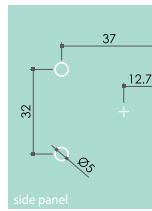

Item No.	Door opening angle
22775	270°



## 22772 Wide Angle Twin Pivot Hinge

- \* 180° opening angle and 6.5mm door overlay
- \* Twin doors mounting
- \* Zamak, nickel plated, with spring catch
- \* Available with nylon dowels (Ø10mm) for hinge cup mounting plate and press-in expansion (Ø5mm) for adjustment

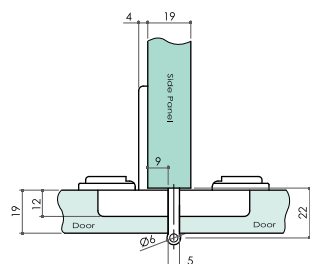
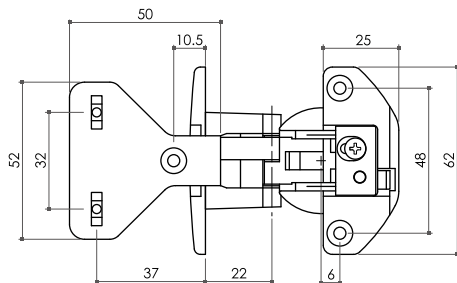
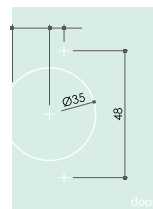
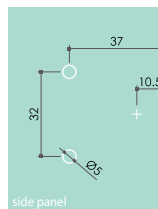

Item No.	Door opening angle
22772	180°



# 04-2 Wide-Open Hinges

## Exposed Knuckle Offset Hinge

- \* 240° opening angle and 3.5mm door overlay
- \* Zamak, nickel plated or black coating, with spring catch
- \* Hardened steel axle with nylon ring for smooth swinging

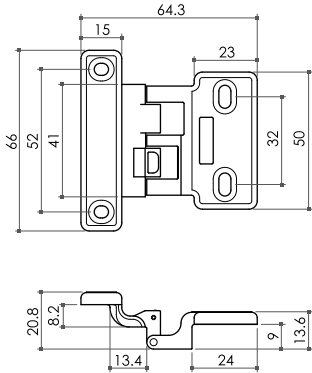
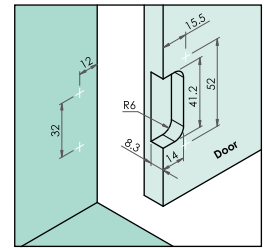
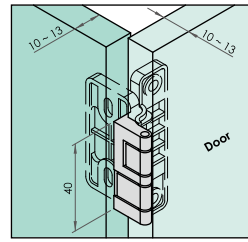

Item No.	Type
22745	with spring catch
22746	without spring catch

## Institutional Hinge

- \* 270° opening angle
- \* Material: 2.5mm thickness steel
- \* Electro plated: satin chrome, satin nickel, polished brass or chrome
- \* Powder coated: black, matt silver gray or pearl gray

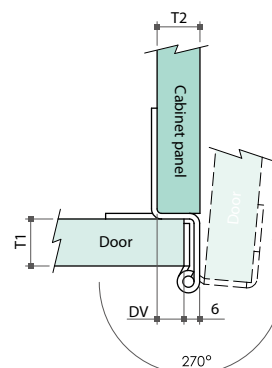
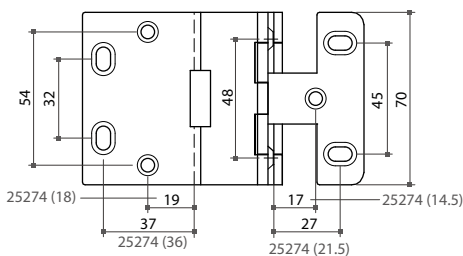

Item No.	Door thickness (T1)	Cabinet thickness (T2)	Door overlay (DV)
25270	21mm	19mm	
25271	21mm	19mm	14mm
25272	21mm	21mm	
25273	21mm	16mm	
25274	29mm	16mm	for inlay door

# 04-2 Wide-Open Hinges

## Economic Wide-Open Knuckle Hinge

- \* 270° opening angle
- \* Material: 1.8mm thickness steel, zinc, bright brass and bronze plated
- \* Mounting type: screw-in fixing

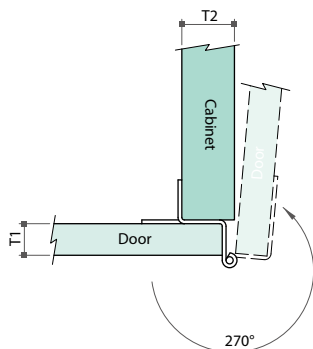

Item No.	Door thickness (T1)	Cabinet thickness (T2)	Door overlay (DV)
25260	19mm	19mm	18.5mm
25261	19mm	21mm	20.5mm

## 20615 Crank Hinge

- \* 1.6mm thickness
- \* Steel, bright, bronzed or antique brass plated

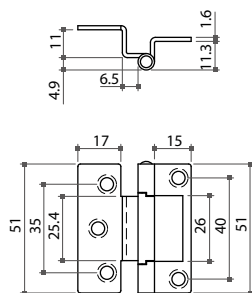

Item No.	Thickness
20615	1.6mm

## 25220 Crank Hinge

- \* 1.8mm thickness
- \* Steel, bright, bronzed brass or nickel plated

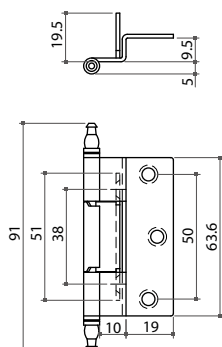

Item No.	Thickness
25220	1.8mm

# 04-3 Easy-On Hinges

## 22316 Easy-On Hinge

- \* 90° opening angle
- \* Spring loaded self-closing
- \* No drilling hole required
- \* Available also in stainless steel

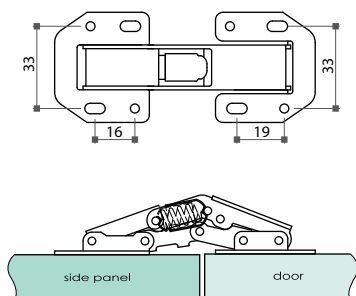

Item No.	Material
22316	steel, nickel plated
22316SS	stainless steel

## 22315 Easy-On Hinge

- \* 150° opening angle
- \* Steel, nickel plated
- \* Spring loaded self-closing
- \* No drilling hole required

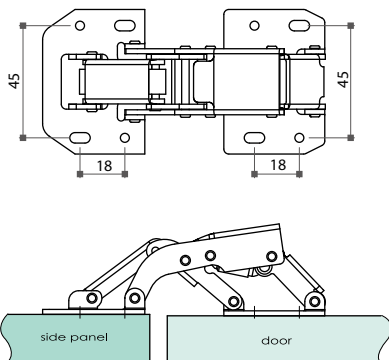
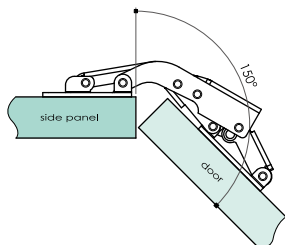

Item No.	Material
22315	steel, nickel plated

# 04-3 Easy-On Hinges

## 22318 Adjustable Easy-On Hinge

- \* Maximum 150° opening angle
- \* Steel, nickel plated
- \* Spring loaded self-closing
- \* No drilling hole required

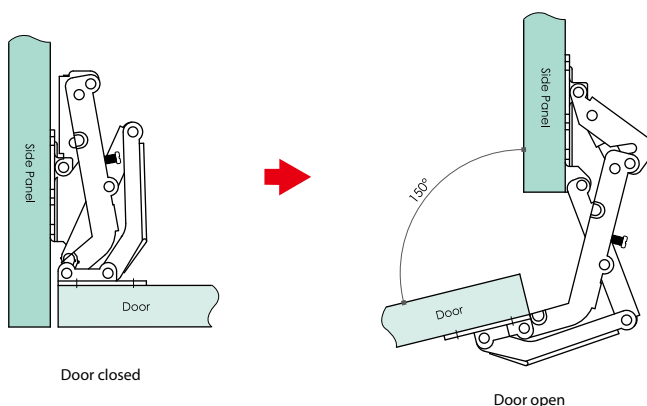
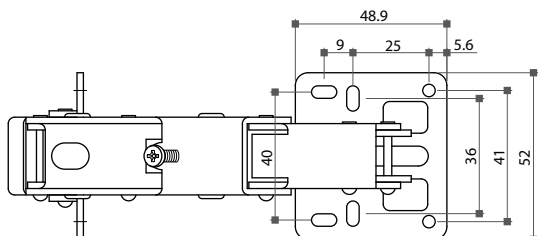

Item No.	Material
22318	steel

## 22319 Easy-On Hinge With Lid Support

- \* 90° opening angle
- \* Steel, nickel plated
- \* Spring loaded self-closing
- \* No drilling hole required
- \* From 16mm face frame door

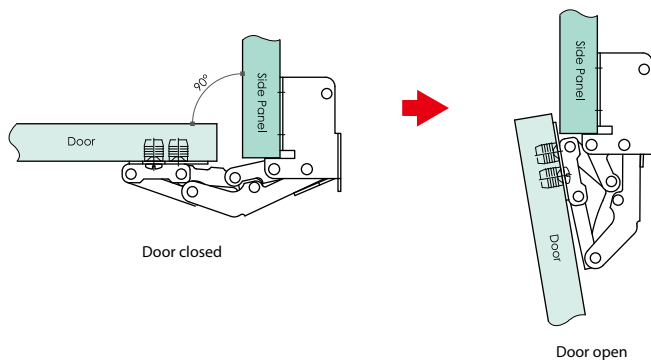
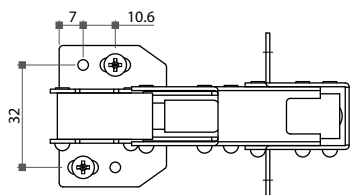

Item No.	Material
22319	steel

# 04-3 Easy-On Hinges

## 22317 Easy-On Hinge With Side-Mount Bracket

- \* 70° opening angle,  $\pm 5^\circ$  adjustable
- \* To be installed on sink-front lid door
- \* Steel, nickel plated, with one set of white powdered bracket
- \* Spring loaded self-closing
- \* Also available in stainless steel

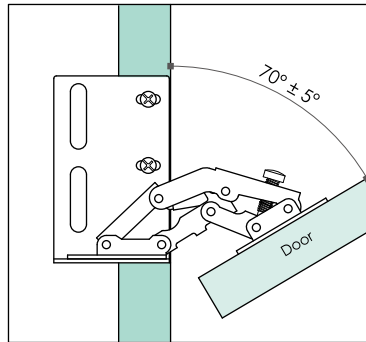
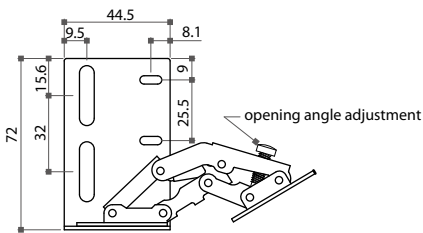
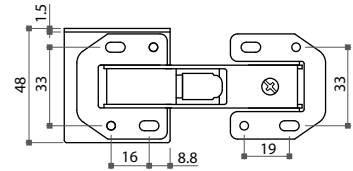

Item No.	Material
22317	steel

## Sink Front Tip-Out Tray

- \* #304 stainless steel tray, film protected, with two key holes
- \* Make use of kitchen sink front to store sponges and cleaners

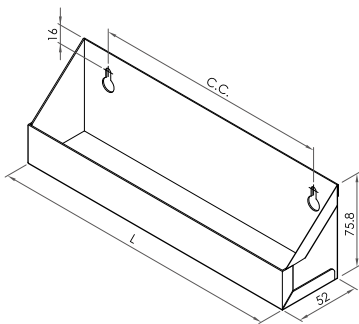

Item No.	C.C.	L
A81011	194mm	238mm
A81012	244mm	290mm
A81013	320mm	366mm



# 04-4 Cylinder Hinges

## SOS Invisible Hinge

- \* 180° opening
- \* Material: zinc alloy & stainless steel #304
- \* Finish: polished chrome, satin chrome, satin nickel or brass



21100

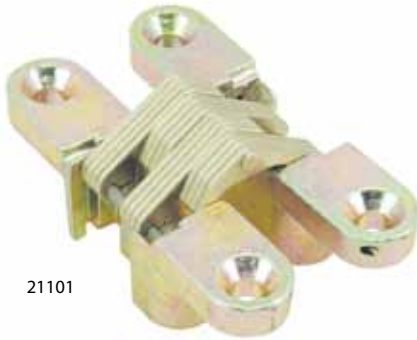

21101



21104



21102

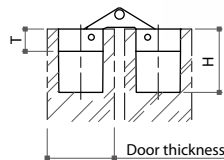
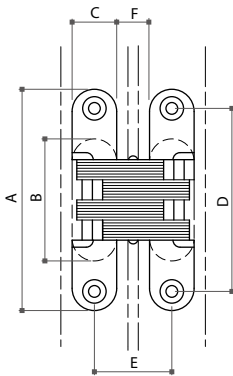

unit: mm

Item No.	A	B	C	D	E	F	T	H	Door thickness	Screw dia.
21100	44.5	18.5	12.6	31.6	21.9	9	4.8	18	18 ~ 20	Ø4.5
21101	60	31.4	12.9	47.5	22	9	6.1	18	19 ~ 21	Ø4.5
21104	70	34	16	52.6	26.6	10	6.9	23	22 ~ 26	Ø4
21102	94	52	19	78	33	14	9.5	27	25 ~ 32	Ø5
21103	117	63	25	91	43	18	12	31	34 ~ 42	Ø6

# 04-4 Cylinder Hinges

## Solid Brass Cylinder Hinge

- \* 180° opening concealed hinge
- \* Finish: bronze, nickel, satin chrome and black plated

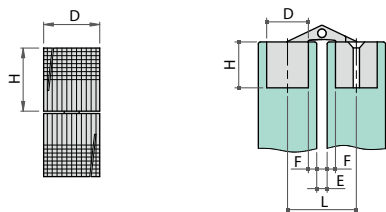
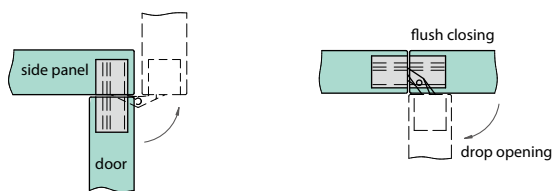
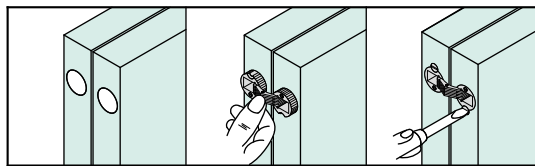

unit: mm

Item No.	D	H	L	E	F
20571	Ø10	11.0	16.5	2.5	2.0
20572	Ø12	13.5	20.0	3.5	2.2
20573	Ø14	15.5	23.0	3.0	3.0
20574	Ø16	16.5	25.0	3.0	3.0
20575	Ø18	17.5	27.0	3.0	3.0
20576	Ø24	25.0	36.5	4.5	4.0



## Solid Brass Concealed Hinge

- \* 180° opening concealed hinge
- \* Finish: nickel, satin chrome and black plated
- \* Fixed with chipboard screws straightly or obliquely

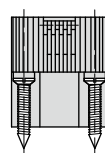

straight screw fixing

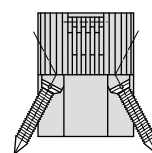

oblique screw fixing

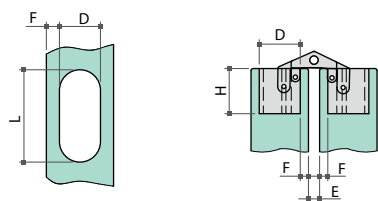
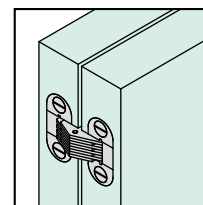

unit: mm

Item No.	D	H	L	E	F
21571B	Ø12	15.5	24	2	3
21572S	Ø12	15.5	27	2	3
21572B	Ø12	15.5	27	2	3



# 04-4 Cylinder Hinges

## 22890 Mortise Nylon Hinge

- \* Material: plastic housing in brown or white
- \* Metal hinge arm in nickel plated
- \* Ø25mm and 14mm depth drilling hole

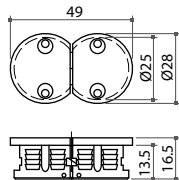

Item No.	Drilling hole size
22890	Ø25x14mm depth

## 22886 Flap Hinge

- \* Material: zinc alloy
- \* Finish: nickel or antique copper plated

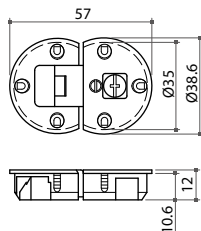
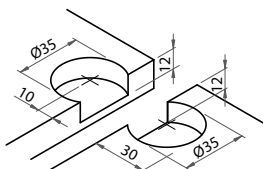

Item No.	Drilling hole size
22886	Ø35x12mm depth

## 22903 Flap Hinge

- \* Material: zinc alloy with plastic
- \* Finish: nickel, brass or antique English plated with brown

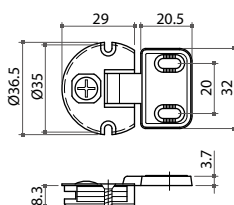
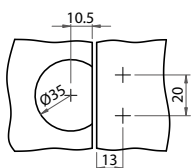

Item No.	Drilling hole size
22903	Ø35x8.3mm depth

## 22880 Flap Hinge

- \* Material: zinc alloy with plastic
- \* Finish: nickel or brass plated with black

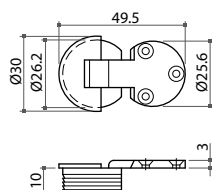
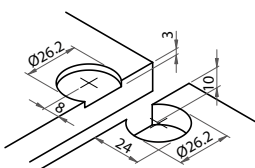

Item No.	Drilling hole size
22880	Ø26.2x10mm depth

# 04-5 Butt Hinges

## Butt Hinge

- \* Material : steel or stainless steel
- \* Finish: zinc plated, brass plated, antique brass & antique copper

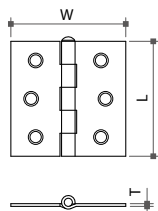

Item No.	Dimension (LxWxT)	Screw hole
21510	100x100x2.3mm	#8
21511	89x89x2.3mm	#8
21512	76x76x2.0mm	#8
21513	64x64x2.0mm	#8
21514	51x51x1.2mm	#5
21515	38x38x1.0mm	#4

## Metric Butt Hinge

- \* Material : steel or stainless steel
- \* Finish: zinc plated, original color

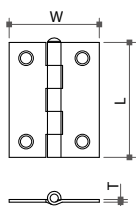

Item No.	Dimension (LxWxT)	Screw hole
21520	100x100x2.5mm	#9
21521	100x75x1.6mm	#7
21522	85x60x1.6mm	#7
21523	70x50x1.6mm	#6
21524	50x40x1.2mm	#5
21525	35x25x1.0mm	#4

## 21535 Radius Hinge (1/4" Radius)

- \* Material : steel
- \* Finish: zinc plated, galvanized

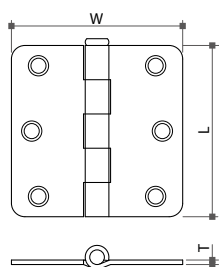

Item No.	Dimension (LxWxT)	Screw hole
21535	76x76x2.0mm	#8

# 04-5 Butt Hinges

## 21050 180° Bi-Fold Hinge

- \* Material: zamak
- \* Finish: black
- \* Spring action with stops at 180°, 90° and 45°

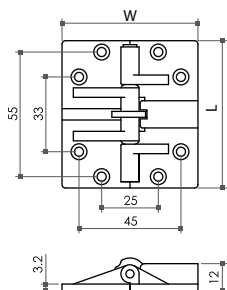

Item No.	Size (LxW)
21050	65x60mm

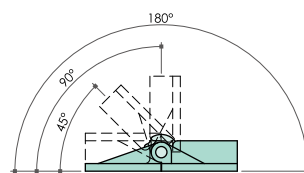

## 21052 180° Bi-Fold Hinge

- \* Spring action with stops at 180°, 90° and 45°

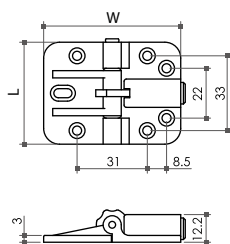

Item No.	Size (LxW)
21052	45x60.5mm

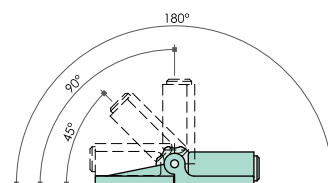

## 21053 90° Bi-Fold Hinge

- \* Spring action with stops at 90° and 45°

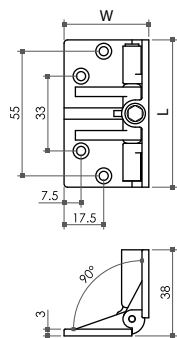

Item No.	Size (LxW)
21053	65x37.4mm

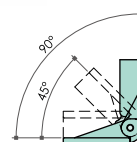

# 04-5 Butt Hinges

## Piano Hinge

- \* Material: steel or stainless steel
- \* Finish: nickel plated, brass plated or original color
- \* Free swing

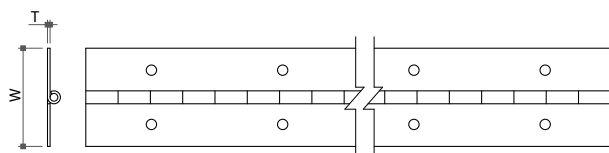

Item No.	W	T
21580	3/4"	0.8mm
21581	1-1/4"	1.0mm
21582	1-1/2"	1.0mm

## Spring Piano Hinge

- \* Material: steel or stainless steel
- \* Finish: nickel plated, brass plated or original color

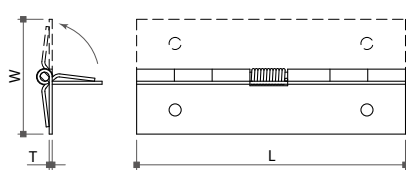

Item No.	Dimension (LxWxT)	Screw hole
21545	89x38x1.0mm	Ø4mm
21546	127x51x1.2mm	Ø4.7mm

## Bar Joint Hinge

- \* Material: steel
- \* Finish: black coated

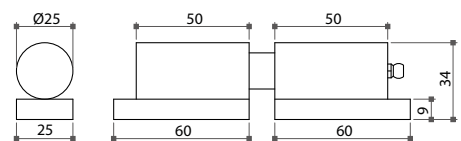

Item No.	Dimension
21540	127x25.4mm
21541	178x15x38mm

# 04-5 Butt Hinges

## "H" Hinge

- \* Flush type, scalloped edge
- \* Finish: black, antique brass or antique copper

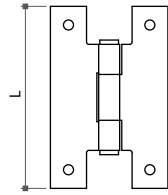

Item No.	L
20522	2-1/2" (with 4 holes)
20523	3" (with 6 holes)

## Ornamental Cabinet Hinge

- \* Steel, brass, chrome, nickel, bronze or black plated
- \* Available with fixed pin: flush type
- \* Also available in solid brass

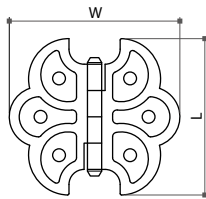

Item No.	Size (LxW)
20190	55x60mm
20193	36x49mm

## Folding Door Butt Hinge

- \* Available with fixed pin: flush type
- \* Steel, zinc, bronze or black plated
- \* For folding door fittings

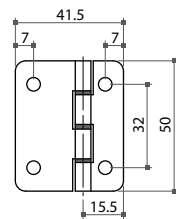

Item No.	Feature
25900	screw holes
25900A	Ø8mm nylon dowels

## Back Flap Hinge

- \* Material: steel
- \* Finish: zinc plated or brass plated

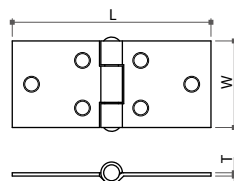

Item No.	Dimension (LxWxT)	Screw hole
21530	4-1/2"x2"x2.3mm	#9
21531	3-1/2"x1-1/2"x1.8mm	#6
21532	2-7/8"x1"x1.8mm	#5

# 04-5 Butt Hinges

## Non-Mortise Hinge

- \* Material: steel or stainless steel
- \* Finish: nickel plated, brass plated or original color

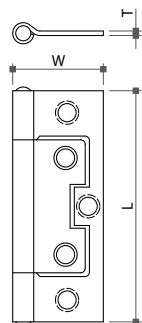

Item No.	Dimension (LxWxT)	Screw hole
21560	100.5x42x2.0mm	#8
21561	76x30x1.5mm	#6
21562	63.5x24.8x1.2mm	#5
21563	51x24x1.2mm	#4

## 21547 Wrap Around Hinge

- \* Material : steel
- \* Finish: antique copper, antique brass or brass plated

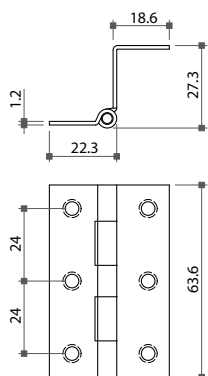

Item No.	L	Thickness	Screw hole
21547	63.5mm	1.2mm	#5

## 21536 Heavy Duty Welding Hinge

- \* Material: steel
- \* Finish: bright steel
- \* With oil ring, brass washer

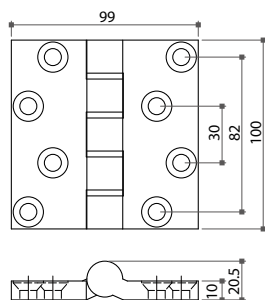

Item No.	Dimension (LxWxT)	Hole dia.
21536	100x98x10mm	Ø9mm



# 04-5 Butt Hinges

## Folding Screen Hinge

\* Steel, antique copper or brass plated

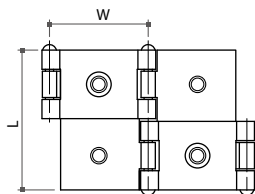
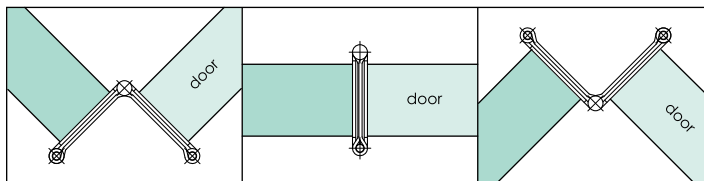

20861 / 20862 / 20864

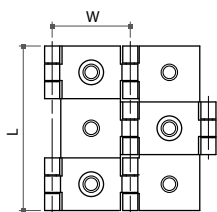

20866

Item No.	Size (LxW)	Wood thickness
20861	44.7x23mm	19mm
20862	48x30mm	25.4mm
20864	51x36mm	32mm
20866	60x28.5mm	



20861



20862



20864



20866

## 20240 Flush Cabinet Hinge

\* Steel, antique copper, brass or zinc plated

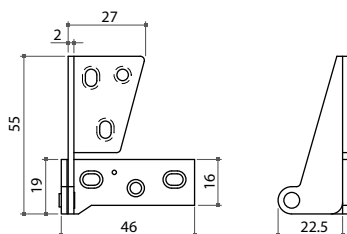

Item No.	Type
20240	for 5/8" overlay

# 04-5 Butt Hinges

## 20110 Free Swing Cabinet Hinge

- \* Without spring action, free swing
- \* Finish: antique brass (AB) or antique copper (AC) plated

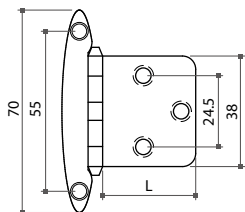
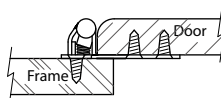

Item No.	Leaf size (L)
20110	32mm

## 20010 Self-Closing Hinge

- \* Spring action, self-closing
- \* Finish: antique brass (AB) or antique copper (AC) plated

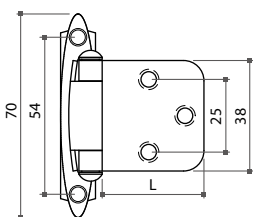
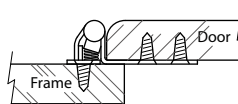

Item No.	Leaf size (L)
20010	35mm

## Self-Closing Cabinet Hinge

- \* Spring action, self-closing
- \* Partial wrap-around, for 1/4" door overlay
- \* Finish: antique brass (AB) or antique copper (AC) plated

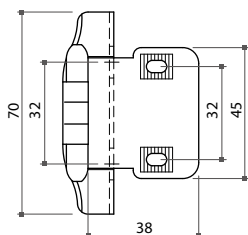
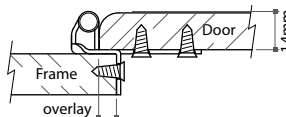

Item No.	Door overlay
20065	1/4"

# 04-5 Butt Hinges

## Lift-Off Hinge

- \* Thickness: 1.2mm
- \* Steel, zinc, nickel or brass plated
- \* For right or left hand door

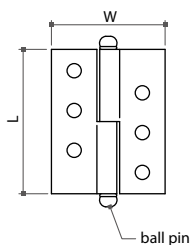

Item No.	Size (LxW)	Type
20564	50x40mm	right hand
20565	50x40mm	left hand
20561	60x43mm	right hand
20562	60x43mm	left hand
20810	100x75mm	right hand
20811	100x75mm	left hand



## Lift-Off Offset Hinge

- \* Thickness: 1.2mm
- \* With ornamental pin
- \* Steel, bronzed or antique brass plated

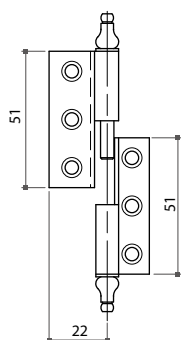

Item No.	Type
20559	right hand
20560	left hand



## Lift-Off "H" Hinge

- \* Thickness: 2.0mm
- \* Steel, bright brass plated and other finishes

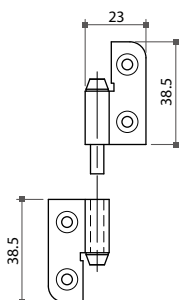

Item No.	Type
20557	right hand
20558	left hand



# 04-5 Butt Hinges

## 20251 Three Leaf Hinge

- \* 1.2mm thickness
- \* Steel, bright brass plated
- \* With nylon washer

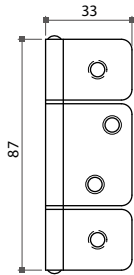

Item No.	Size (LxW)
20251	87x33mm

## 20673 Mon-Mortise Hinge

- \* 1.4mm thickness
- \* With steel ring

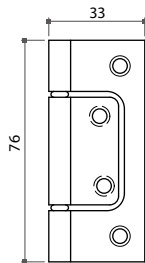

Item No.	Size (LxW)
20673	76x33mm

## Hirline Hinge

- \* Available with flat back or swaged type
- \* Finish: antique copper, brass plated

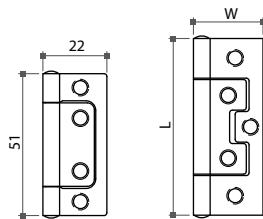

20501



Item No.	Size (LxW)	Thickness
20501	51x22mm	1.1mm
20502	63.5x25.4mm	1.3mm
20503	76x29mm	1.4mm

## Cabinet Hinge

- \* With minaret tip
- \* Available with flat back or swaged type
- \* Finish: antique copper, brass plated

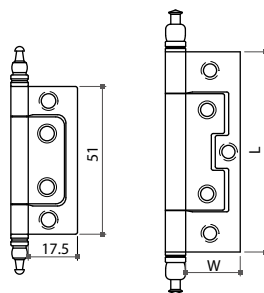

20640



Item No.	Size (LxW)	Thickness
20640	51x17.5mm	1.1mm
20641	63.5x19mm	1.3mm
20642	76x21mm	1.4mm

# 04-6 Pivot & Flap Hinges

## 20360 Pivot Hinge

- \* For inset door
- \* Each set consists of:
  - 1) 2 pcs of die casting back part, steel hinge, plastic bushing and flat head screw M4x6mm
  - 2) 4 pcs of wood screw 3x12mm pan head

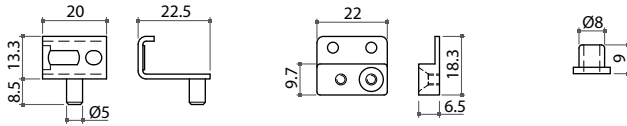
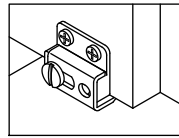

Item No.	Size
20360	20x13.3mm

## Wooden Door Pivot Hinge

- \* Finish: black, chrome, brass plated
- \* Each set consists of:
  - 1) 1 pair of hinges (upper and lower)
  - 2) 2 pcs of plastic bushing
  - 3) 4 pcs of wood screw

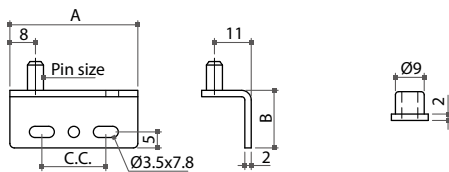

Item No.	Size (AxB)	C.C.	Pin size
21641	40x18mm	20mm	Ø5x9mm
21642	40x18mm	32mm	Ø5x9mm
21647	44x19mm	32mm	Ø5x9mm
21648	50x19mm	32mm	Ø5x9mm
21650	40x18mm	20mm	Ø4x8mm
21651	40x18mm	32mm	Ø4x8mm

## 21630 Wooden Door Pivot Hinge

- \* Finish: black or brass plated
- \* Each set consists of:
  - 1) 1 pair of hinges (upper and lower)
  - 2) 2 pcs of plastic bushing
  - 3) 4 pcs of wood screw

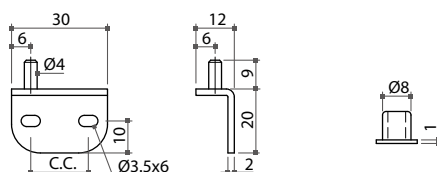

Item No.	Size	C.C.	Pin size
21630	30x20mm	18mm	Ø4x9mm

**Алматы** (7273)495-231  
**Ангарск** (3955)60-70-56  
**Архангельск** (8182)63-90-72  
**Астрахань** (8512)99-46-04  
**Барнаул** (3852)73-04-60  
**Белгород** (4722)40-23-64  
**Благовещенск** (4162)22-76-07  
**Брянск** (4832)59-03-52  
**Владивосток** (423)249-28-31  
**Владикавказ** (8672)28-90-48  
**Владимир** (4922)49-43-18  
**Волгоград** (844)278-03-48  
**Вологда** (8172)26-41-59  
**Воронеж** (473)204-51-73  
**Екатеринбург** (343)384-55-89

**Иваново** (4932)77-34-06  
**Ижевск** (3412)26-03-58  
**Иркутск** (395)279-98-46  
**Казань** (843)206-01-48  
**Калининград** (4012)72-03-81  
**Калуга** (4842)92-23-67  
**Кемерово** (3842)65-04-62  
**Киров** (8332)68-02-04  
**Коломна** (4966)23-41-49  
**Кострома** (4942)77-07-48  
**Краснодар** (861)203-40-90  
**Красноярск** (391)204-63-61  
**Курск** (4712)77-13-04  
**Курган** (3522)50-90-47  
**Липецк** (4742)52-20-81

**Магнитогорск** (3519)55-03-13  
**Москва** (495)268-04-70  
**Мурманск** (8152)59-64-93  
**Набережные Челны** (8552)20-53-41  
**Нижний Новгород** (831)429-08-12  
**Новокузнецк** (3843)20-46-81  
**Ноябрьск** (3496)41-32-12  
**Новосибирск** (383)227-86-73  
**Омск** (3812)21-46-40  
**Орел** (4862)44-53-42  
**Оренбург** (3532)37-68-04  
**Пенза** (8412)22-31-16  
**Петрозаводск** (8142)55-98-37  
**Псков** (8112)59-10-37

**Пермь** (342)205-81-47  
**Ростов-на-Дону** (863)308-18-15  
**Рязань** (4912)46-61-64  
**Самара** (846)206-03-16  
**Саранск** (8342)22-96-24  
**Санкт-Петербург** (812)309-46-40  
**Саратов** (845)249-38-78  
**Севастополь** (8692)22-31-93  
**Симферополь** (3652)67-13-56  
**Смоленск** (4812)29-41-54  
**Сочи** (862)225-72-31  
**Ставрополь** (8652)20-65-13  
**Сургут** (3462)77-98-35  
**Сыктывкар** (8212)25-95-17  
**Тамбов** (4752)50-40-97

**Тверь** (4822)63-31-35  
**Тольятти** (8482)63-91-07  
**Томск** (3822)98-41-53  
**Тула** (4872)33-79-87  
**Тюмень** (3452)66-21-18  
**Ульяновск** (8422)24-23-59  
**Улан-Удэ** (3012)59-97-51  
**Уфа** (347)229-48-12  
**Хабаровск** (4212)92-98-04  
**Чебоксары** (8352)28-53-07  
**Челябинск** (351)202-03-61  
**Череповец** (8202)49-02-64  
**Чита** (3022)38-34-83  
**Якутск** (4112)23-90-97  
**Ярославль** (4852)69-52-93

Россия +7(495)268-04-70

Казахстан +7(7172)727-132

Киргизия +996(312)96-26-47

[www.fourwinds.nt-rt.ru](http://www.fourwinds.nt-rt.ru) | | [fse@nt-rt.ru](mailto:fse@nt-rt.ru)